

| | |
|---|---------------------|
| First Floor | 1215 sq ft |
| Living | 12' x 17' |
| Dining | 12'-6" x 13' |
| Kitchen | 11'-6" x 13' |
| Bedroom 1 | 11' x 16' |
| Laundry/Office | 11' x 8' |
| Bath 1 | full |
| Bath 2 | half |
| Second Floor | 680 sq ft |
| Bedroom 2 | 11'-8" x 13' |
| Bedroom 3 | 11'-8" x 10'-3" |
| Den | 7' x 13' |
| Bath 3 | full |
| Attic >5' | 196 sq ft |
| Total Area | 2091 sq ft |
| Basement Level | 460 sq ft |
| Total Overall (incl. basement) | 2551 sq ft |
| Covered Porch | 269 sf |
| Footprint (includes porches and deck) | 37'-6" x 46' |

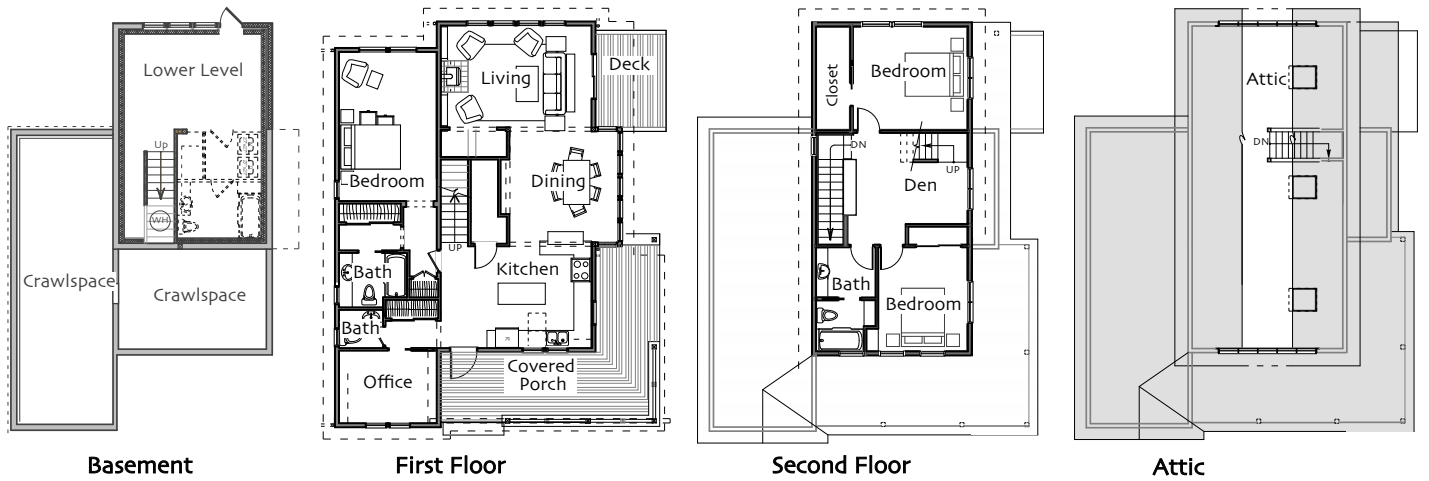

© Ross Chapin Architects • Sizes are approximate / Plans are subject to change