

First Floor 1215 sq ft
 Living 12' x 17'
 Dining 12'-6" x 13'
 Kitchen 11'-6" x 13'
 Bedroom 1 11' x 17'
 Laundry/Office 11' x 8'
 Bath 1 full
 Bath 2 half
 Covered Porch 269 sf

Second Floor 680 sq ft
 Bedroom 2 11'-8" x 13'
 Bedroom 3 11'-8" x 10'-3"
 Den 7' x 13'
 Bath 3 full

Attic >5' 196 sq ft

Total Area 2091 sq ft

Basement Level 460 sq ft

Total Overall 2551 sq ft
 (incl. basement)

Footprint 37'-6" x 46'
 (includes porches and deck)

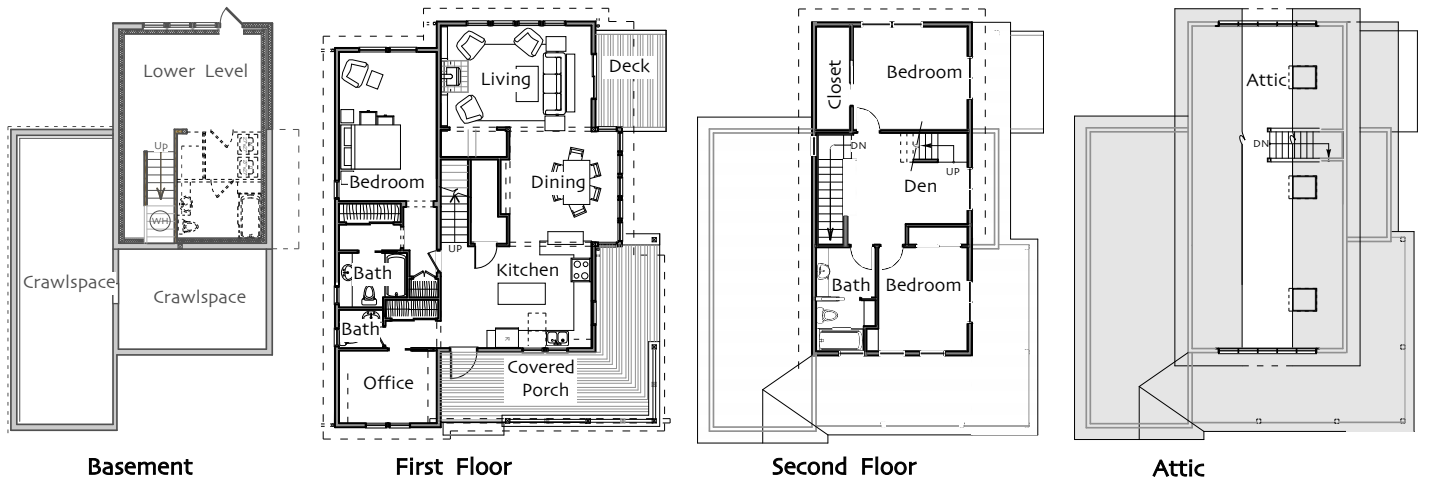

© Ross Chapin Architects • Sizes are approximate / Plans are subject to change

GoodFit
 Cottages and Small Houses

PO Box 230 • Langley, Washington 98260 • plans@rosschapin.com • www.rosschapin.com

Vinnlee